

Motive Battery

Energy Storage Battery

Reserve Battery

Motorcycle Battery



## Maintenance Free-High Rate UPS Battery-TNX Series

# TNX12-480W

(12V 484W, 15min@1.67Vpc)

(12V 128Ah, C10 @1.80Vpc)

### GENERAL FEATURES

- ♦ Oxygen recombination technology: maintenance-free, no need to add water or acid during application
- ♦ Optimized plate design to increase power output at 15min backup time, high performance in high-rate discharge
- ♦ Wide operating temperature range from -20°C to 55°C, excellent deep discharge recovery capability
- ♦ New structure for plate grid, good corrosion resistance and greatly reduced resistance of the battery,
- ♦ 12 years design life @25°C, low self-discharge rate

### Application

- ♦ UPS ( High Rate )
- ♦ Communication Equipments
- ♦ Security systems
- ♦ Data & Network centers
- ♦ Emergency power supply ( EPS )
- ♦ Bank and financial system
- ♦ Hospitals & Testing laboratories

### Dimension

Unit:mm

Length 408±2mm / 16.06inch

Width 177±2mm / 6.97inch

Container Height 225±3mm / 8.86inch

Total Height 225±3mm / 8.86inch

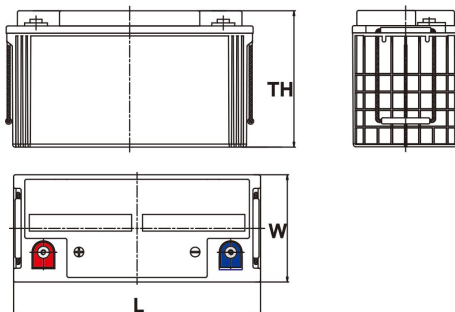

### Terminal

Unit:mm

Terminal Type: I7

### Weight

37.6kg 83.13lbs

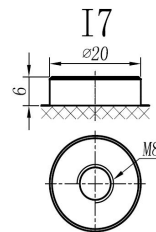

This document is subject to change without prior notification

- Motive Battery
- Energy Storage Battery
- Reserve Battery
- Motorcycle Battery



## TNX12-480W

### Specification

<b>Nominal Voltage</b>	12V	
<b>Rated Power (15min Rate 25°C)</b>	484W F.V (1.67V/cell)	
<b>Rated Capacity (10HR 25°C)</b>	128Ah (1.80V/cell)	
<b>Dimension</b>	<b>Length</b>	408±2mm / 16.06inch
	<b>Width</b>	177±2mm / 6.97inch
	<b>Container Height</b>	225±3mm / 8.86inch
	<b>Total Height</b>	225±3mm / 8.86inch
<b>Weight</b>	37.6kg / 83.13lbs	
<b>Terminal</b>	I7	
<b>Container Material</b>	ABS ( Flame-retardant ABS UL94-V0 is optional )	
<b>Operating Temperature Range</b>	<b>Discharge</b>	-20 ~ +50°C
	<b>Charge</b>	0 ~ +40°C
	<b>Storage</b>	-15 ~ +40°C
<b>Capacity Effected by Temperature</b>	<b>40°C / 104°F</b>	106%
	<b>25°C / 77°F</b>	100%
	<b>0°C / 32°F</b>	86%
	<b>-10°C / 14°F</b>	65%
<b>Charge</b>	<b>Float Voltage</b>	2.25 -2.27V/cell@25°C, Tem.Coefficient : -3mV/cell/°C
	<b>Equalize Voltage</b>	2.40 -2.50V/cell@25°C, Tem.Coefficient : -3mV/cell/°C
	<b>Cycle Voltage</b>	2.40 -2.50V/cell@25°C, Tem.Coefficient : -5mV/cell/°C
<b>Max. Charging Current</b>	38.4A ( 0.3C )	
<b>Max. Discharge Current (5S)</b>	1300A	
<b>Internal Resistance</b>	4mΩ	
<b>Self-Discharge</b>	<3%, TNX series stored at 25 °C require a supplementary charge every six months, the charging interval would shrink when the ambient temperature went higher	

### Discharge Performance

Constant Current Discharge Table (25°C/77°F) Unit: A															
F.V/Time	5min	10min	15min	20min	30min	45min	1h	2h	3h	4h	5h	6h	8h	10h	20h
1.85V/cell	258.1	211.4	187.9	160.9	121.6	90.6	71.69	41.04	29.83	24.01	20.22	17.57	14.88	12.286	6.409
1.80V/cell	324.8	249.9	214.1	180.6	133.5	97.2	76.63	43.26	31.44	25.13	21.01	18.38	15.45	12.772	6.666
1.75V/cell	372.3	279.6	236.8	195.0	140.2	100.5	79.72	44.68	32.22	25.63	21.59	18.87	15.62	12.854	6.724
1.70V/cell	404.9	304.8	252.1	205.4	146.8	104.6	82.69	46.10	33.12	26.29	22.17	19.28	15.84	13.019	6.798
1.67V/cell	440.5	324.8	270.9	215.4	152.5	108.4	85.78	47.59	34.07	27.04	22.66	19.69	16.02	13.151	6.860
1.60V/cell	480.6	345.6	279.8	223.2	157.5	111.2	87.88	48.88	34.86	27.62	23.11	20.15	16.25	13.324	6.946

Constant Power Discharge Table (25°C/77°F) Unit: W															
F.V/Time	5min	10min	15min	20min	30min	45min	1h	2h	3h	4h	5h	6h	8h	10h	20h
1.85V/cell	474.7	392.7	352.4	304.2	231.5	173.4	137.78	79.27	57.86	46.73	39.48	34.39	29.21	24.167	12.631
1.80V/cell	592.0	460.9	399.0	339.4	252.9	185.3	146.83	83.31	60.76	48.75	40.86	35.82	30.21	25.023	13.087
1.75V/cell	672.4	511.9	438.6	364.9	264.4	191.0	152.36	85.79	62.05	49.53	41.85	36.65	30.43	25.096	13.147
1.70V/cell	720.8	550.7	461.5	380.3	274.4	197.1	156.73	87.79	63.31	50.39	42.60	37.15	30.59	25.201	13.185
1.67V/cell	771.3	577.8	483.8	393.8	281.9	202.3	161.08	89.82	64.61	51.46	43.24	37.68	30.73	25.276	13.204
1.60V/cell	821.5	601.6	495.0	400.1	285.7	204.0	162.53	90.91	65.13	51.82	43.49	38.05	30.76	25.268	13.194

动力电池

储能电池

备用电池

摩托车电池



## 阀控免维护-高功率UPS电池-TNX系列

# TNX12-480W

(12V 484W, 15min@1.67Vpc)

(12V 128Ah, C10 @1.80Vpc)

### 产品特点：

- ◆ 氧复合技术: 阀控式免维护，使用期间无需加水或加酸
- ◆ 极板优化处理，提升15分钟放电性能，高倍率放电性能优异
- ◆ 在-20°C到55°C温度区间内均可正常使用，深放电恢复能力出色
- ◆ 隔板特色设计，抗腐蚀性佳，同时大幅度降低电池内阻
- ◆ 12年设计寿命（25°C），自放电率低

### 产品应用

- ◆ 不间断电源(高功率)
- ◆ 通讯设备
- ◆ 安全系统
- ◆ 数据网络中心
- ◆ 应急电源系统
- ◆ 银行资金系统
- ◆ 医疗测试设备

### 尺寸

单个尺寸

长	408±2mm / 16.06inch
宽	177±2mm / 6.97inch
高	225±3mm / 8.86inch
总高	225±3mm / 8.86inch

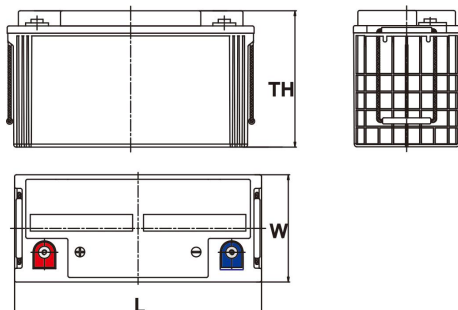

### 端子类型

单位:mm

端子类型 I7

### 重量

37.6kg 83.13lbs

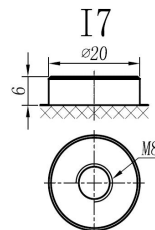

ISO9001 ISO14001 OHSAS18001

内容如有改动，恕不另行通知

动力电池

储能电池

备用电池

摩托车电池



## TNX12-480W

### 规格书

额定电压	12V	
15分钟放电功率	484W F.V (1.67V/cell)	
额定容量 (10小时)	128Ah (1.80V/cell)	
尺寸	长	408±2mm
	宽	177±2mm
	高	225±3mm
	总高	225±3mm
重量	37.6kg	
端子	I7	
壳体材料	ABS (阻燃ABS壳体可选)	
使用温度范围	放电	-20 ~ +50°C
	充电	0 ~ +40°C
	储存	-15 ~ +40°C
不同温度下 电池容量系数	40°C / 104°F	106%
	25°C / 77°F	100%
	0°C / 32°F	86%
	-10°C / 14°F	65%
充电	浮充电压	2.25 -2.27V/单格@25°C, 温度补偿系数: -3mV/单格/°C
	均充电压	2.40 -2.50V/单格@25°C, 温度补偿系数: -3mV/单格/°C
	循环使用电压	2.40 -2.50V/单格@25°C, 温度补偿系数: -5mV/单格/°C
最大充电电流	38.4A (0.3C)	
最大放电电流 (5S)	1300A	
电阻	4mΩ	
自放电	<3%, TNX系列储存在25°C时需每6个月进行一次补充充电, 环境温度更高时则充电间隔时间越短	

### 放电性能

恒电流放电表 (25°C/77°F) 单位: A															
F.V/Time	5min	10min	15min	20min	30min	45min	1h	2h	3h	4h	5h	6h	8h	10h	20h
1.85V/cell	258.1	211.4	187.9	160.9	121.6	90.6	71.69	41.04	29.83	24.01	20.22	17.57	14.88	12.286	6.409
1.80V/cell	324.8	249.9	214.1	180.6	133.5	97.2	76.63	43.26	31.44	25.13	21.01	18.38	15.45	12.772	6.666
1.75V/cell	372.3	279.6	236.8	195.0	140.2	100.5	79.72	44.68	32.22	25.63	21.59	18.87	15.62	12.854	6.724
1.70V/cell	404.9	304.8	252.1	205.4	146.8	104.6	82.69	46.10	33.12	26.29	22.17	19.28	15.84	13.019	6.798
1.67V/cell	440.5	324.8	270.9	215.4	152.5	108.4	85.78	47.59	34.07	27.04	22.66	19.69	16.02	13.151	6.860
1.60V/cell	480.6	345.6	279.8	223.2	157.5	111.2	87.88	48.88	34.86	27.62	23.11	20.15	16.25	13.324	6.946

恒功率放电表 (25°C/77°F) 单位: W															
F.V/Time	5min	10min	15min	20min	30min	45min	1h	2h	3h	4h	5h	6h	8h	10h	20h
1.85V/cell	474.7	392.7	352.4	304.2	231.5	173.4	137.78	79.27	57.86	46.73	39.48	34.39	29.21	24.167	12.631
1.80V/cell	592.0	460.9	399.0	339.4	252.9	185.3	146.83	83.31	60.76	48.75	40.86	35.82	30.21	25.023	13.087
1.75V/cell	672.4	511.9	438.6	364.9	264.4	191.0	152.36	85.79	62.05	49.53	41.85	36.65	30.43	25.096	13.147
1.70V/cell	720.8	550.7	461.5	380.3	274.4	197.1	156.73	87.79	63.31	50.39	42.60	37.15	30.59	25.201	13.185
1.67V/cell	771.3	577.8	483.8	393.8	281.9	202.3	161.08	89.82	64.61	51.46	43.24	37.68	30.73	25.276	13.204
1.60V/cell	821.5	601.6	495.0	400.1	285.7	204.0	162.53	90.91	65.13	51.82	43.49	38.05	30.76	25.268	13.194